



Drop-cell connector for
thin-film electrodes

Drop-cell connector



The new drop-cell connector (Ref. ED-DROP-CELL) provides a true user-friendly interface with the potentiostat for the thin-film (micro)electrodes supplied by MicruX Technologies.

» Drop-cell connector features

The drop-cell connector enables the use of microvolume (1 – 10 μL sample drops) with all standard (10 x 6 mm) thin-film (micro)electrodes supplied by MicruX Technologies.

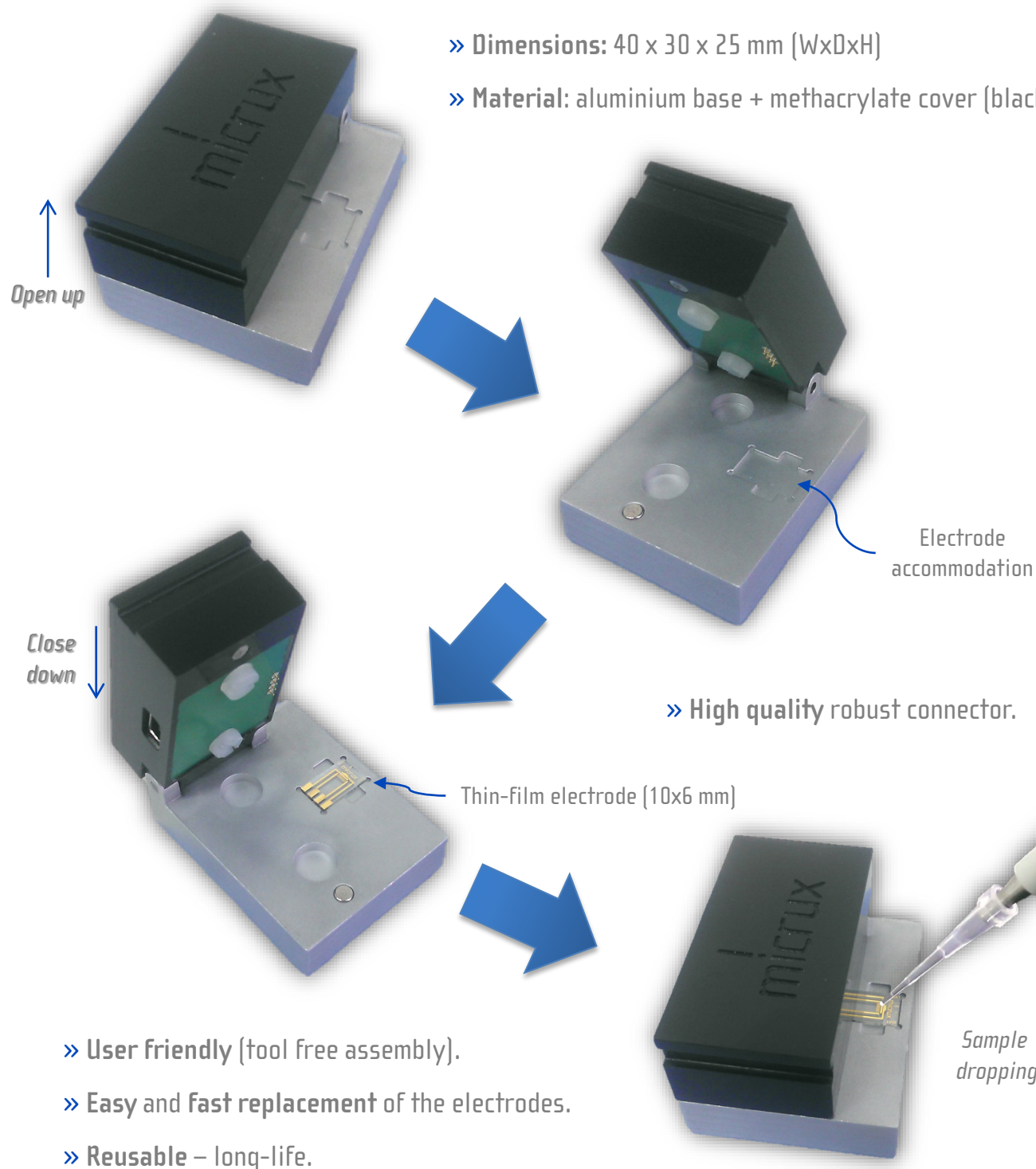



» Drop-cell potentiostat-interfacing

» Connector back view

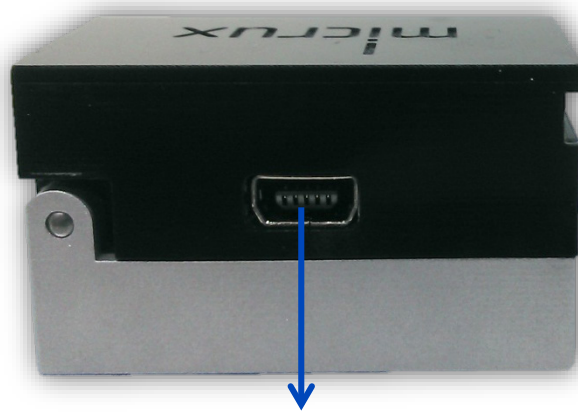

Integrated easy-to-use connector (miniUSB-type connector) with pogo-pins.

» Universal cable

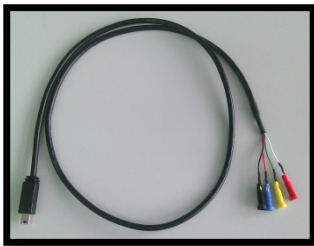

The drop-cell connector is supplied with an universal cable compatible with any commercial potentiostat.



miniUSB to EC Drop/Flow-cell

Female/male banana plug to potentiostat

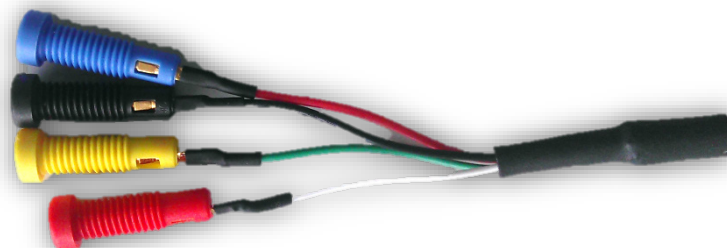

Plug to potentiostat may be available in other format under previous request.



Mora-Garay Industrial Park · Juan de la Cierva, 2C, Bldg. # 6
33211 · Gijón (Asturias) · SPAIN

Phone/FAX: +34 984151019

E-mail: info@micruxfluidic.com

Web: www.micruxfluidic.com

